

MS系列功率電感 MS SERIES SMD POWER INDUCTORS

MS系列功率電感 MS SERIES SMD POWER INDUCTORS



• 特征 FEATURES

- 大電流; • High saturation current
- 屏蔽結構; • Magnetic shielded
- 適合于表面貼裝, 適合于回流焊。 • SMT type, suitable for reflow soldering.

• 應用APPLICATION:

- 辦公自動化設備, 筆記本電腦; • OA equipment, Notebook Computer
- LCD電視; • LCD televisions
- DC/DC轉換。 • DC/DC converters etc.

• 產品規格型號的表示方法 ORDERING CODE

MS 127 — 101 M T
① ② ③ ④ ⑤

NSCN® | WWW.NSCN.COM.CN
 总机: 025-52188228 客服: 400-888-5058
 技术: 025-84712971 邮箱: TECH@NSCN.COM.CN
 南京南山半导体有限公司

| ① 產品代號 Product Code | | ② 規格尺寸(L×W×T) Dimensions (L×W×T) (mm) | | ③ 電感量(μH) Inductance | | ④ 誤差 Tolerance | | ⑤ 包裝方式 Packaging Style | |
|---------------------------|--------------|--|---------------|----------------------------|------|----------------------|------|------------------------------|-------------------|
| MS | MS系列 功率電感 | 73 | 7.3×7.3×3.4 | 150 | 15 | M | ±20% | T | 卷帶盤裝 Tape&Reel |
| | | 74 | 7.3×7.3×4.2 | 101 | 100 | N | ±30% | B | 散裝Bulk |
| | | 124 | 12.2×12.2×4.5 | 102 | 1000 | | | | |
| | | 127 | 12.2×12.2×7.5 | | | | | | |

• 外形尺寸 SHAPE AND DIMENSIONS

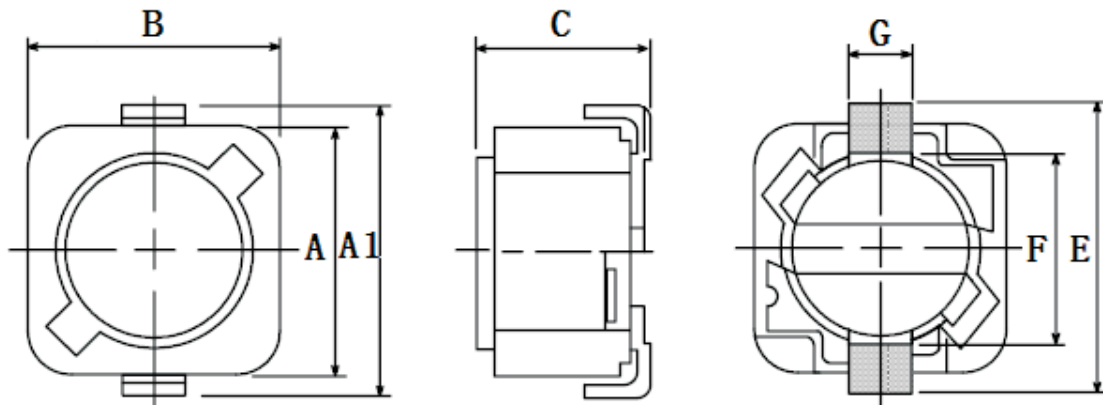

Unit: mm

| 型號Part | A | A1 | B | C | E | F | F |
|--------|---------|---------|---------|---------|---------|---------|---------|
| MS62 | 5.9±0.3 | 6.6±0.3 | 6.2±0.3 | 2.7±0.3 | 6.6±0.3 | 4.6±0.2 | 1.5±0.2 |

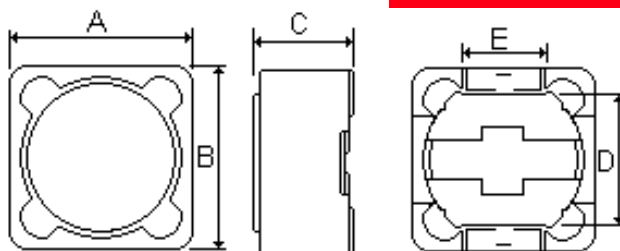

Unit: mm

| 型號Part | A | B | C | D | E |
|--------|----------|----------|---------|-----|-----|
| MS73 | 7.3±0.3 | 7.3±0.3 | 3.4±0.3 | 5.0 | 2.0 |
| MS74 | 7.3±0.3 | 7.3±0.3 | 4.2±0.3 | 5.0 | 2.0 |
| MS124 | 12.2±0.4 | 12.2±0.4 | 4.5±0.3 | 7.6 | 5.0 |
| MS125 | 12.2±0.4 | 12.2±0.4 | 5.7±0.3 | 7.6 | 5.0 |
| Ms127 | 12.2±0.4 | 12.2±0.4 | 7.5±0.3 | 7.6 | 5.0 |

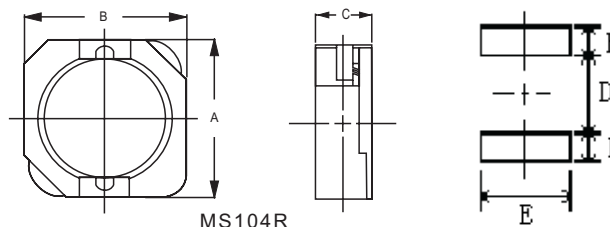

MS104R

Unit: mm

| 型號Part | A | B | C | D | E | F |
|--------|----------|----------|--------|-----|-----|-----|
| MS104R | 10.2±0.3 | 10.0±0.3 | 4.0MAX | 7.8 | 3.0 | 1.2 |

■ 電性能參數 ELECTRICAL CHARACTERISTICS

MS62 Series

| 型號 Part Number | 電感量 L(μH) | 公差 Tolerance | 測試頻率 Test Freq. | 直流電阻 DCR(Ω)Max | Isat(A) |
|-------------------|--------------|-----------------|--------------------|-------------------|---------|
| MS62-6R8NT | 6.8 | ± 30% | 1kHz | 0.120 | 1.70 |
| MS62-100MT | 10 | ± 20% | 1kHz | 0.170 | 1.60 |
| MS62-150MT | 15 | ± 20% | 1kHz | 0.260 | 1.30 |
| MS62-220MT | 22 | ± 20% | 1kHz | 0.380 | 1.00 |
| MS62-330MT | 33 | ± 20% | 1kHz | 0.480 | 0.64 |
| MS62-470MT | 47 | ± 20% | 1kHz | 0.770 | 0.53 |
| MS62-101MT | 100 | ± 20% | 1kHz | 1.500 | 0.45 |

Isat: 飽和電流，加Isat時，電感值相對初始值下降 ≤ 20%

Isat: Saturation Current, the current when the inductance becomes 20% lower than its initial value.

MS系列功率电感

MS SERIES SMD POWER INDUCTORS

MS73 Series

| 型號 Part Number | 電感量 L(μH) | 公差 Tolerance | 測試頻率 Test Freq. | 直流電阻 DCR(Ω)Max | Isat(A) |
|-------------------|--------------|-----------------|--------------------|-------------------|---------|
| MS73-1R0NT | 1.0 | ±30% | 1kHz | 0.025 | 3.60 |
| MS73-2R2NT | 2.2 | ±30% | 1kHz | 0.035 | 2.50 |
| MS73-100MT | 10 | ±20% | 1kHz | 0.072 | 1.68 |
| MS73-120MT | 12 | ±20% | 1kHz | 0.098 | 1.52 |
| MS73-150MT | 15 | ±20% | 1kHz | 0.130 | 1.33 |
| MS73-180MT | 18 | ±20% | 1kHz | 0.140 | 1.20 |
| MS73-220MT | 22 | ±20% | 1kHz | 0.190 | 1.07 |
| MS73-270MT | 27 | ±20% | 1kHz | 0.210 | 0.96 |
| MS73-330MT | 33 | ±20% | 1kHz | 0.240 | 0.91 |
| MS73-390MT | 39 | ±20% | 1kHz | 0.320 | 0.77 |
| MS73-470MT | 47 | ±20% | 1kHz | 0.360 | 0.76 |
| MS73-560MT | 56 | ±20% | 1kHz | 0.470 | 0.68 |
| MS73-680MT | 68 | ±20% | 1kHz | 0.520 | 0.61 |
| MS73-820MT | 82 | ±20% | 1kHz | 0.690 | 0.57 |
| MS73-101MT | 100 | ±20% | 1kHz | 0.790 | 0.50 |
| MS73-121MT | 120 | ±20% | 1kHz | 0.890 | 0.49 |
| MS73-151MT | 150 | ±20% | 1kHz | 1.270 | 0.43 |
| MS73-181MT | 180 | ±20% | 1kHz | 1.450 | 0.39 |
| MS73-221MT | 220 | ±20% | 1kHz | 1.650 | 0.35 |
| MS73-271MT | 270 | ±20% | 1kHz | 2.310 | 0.32 |
| MS73-331MT | 330 | ±20% | 1kHz | 2.620 | 0.28 |
| MS73-391MT | 390 | ±20% | 1kHz | 2.940 | 0.26 |
| MS73-471MT | 470 | ±20% | 1kHz | 4.180 | 0.24 |
| MS73-561MT | 560 | ±20% | 1kHz | 4.670 | 0.22 |
| MS73-681MT | 680 | ±20% | 1kHz | 5.730 | 0.19 |
| MS73-821MT | 820 | ±20% | 1kHz | 6.540 | 0.18 |
| MS73-102MT | 1000 | ±20% | 1kHz | 9.440 | 0.16 |

Ms74 Series

| 型號 Part Number | 電感量 L(μH) | 公差 Tolerance | 測試頻率 Test Freq. | 直流電阻 DCR(Ω)Max | Isat(A) |
|-------------------|--------------|-----------------|--------------------|-------------------|---------|
| MS74-1R0NT | 1.0 | ±30% | 1kHz | 0.022 | 6.00 |
| MS74-2R2NT | 2.2 | ±30% | 1kHz | 0.030 | 3.00 |
| MS74-100MT | 10 | ±20% | 1kHz | 0.049 | 1.84 |
| MS74-120MT | 12 | ±20% | 1kHz | 0.058 | 1.71 |
| MS74-150MT | 15 | ±20% | 1kHz | 0.081 | 1.47 |
| MS74-180MT | 18 | ±20% | 1kHz | 0.091 | 1.31 |
| MS74-220MT | 22 | ±20% | 1kHz | 0.110 | 1.23 |
| MS74-330MT | 33 | ±20% | 1kHz | 0.170 | 0.96 |
| MS74-390MT | 39 | ±20% | 1kHz | 0.230 | 0.91 |
| MS74-470MT | 47 | ±20% | 1kHz | 0.260 | 0.88 |
| MS74-560MT | 56 | ±20% | 1kHz | 0.350 | 0.75 |
| MS74-680MT | 68 | ±20% | 1kHz | 0.380 | 0.69 |
| MS74-820MT | 82 | ±20% | 1kHz | 0.430 | 0.61 |
| MS74-101MT | 100 | ±20% | 1kHz | 0.610 | 0.60 |
| MS74-121MT | 120 | ±20% | 1kHz | 0.660 | 0.52 |
| MS74-151MT | 150 | ±20% | 1kHz | 0.880 | 0.46 |
| MS74-181MT | 180 | ±20% | 1kHz | 0.980 | 0.42 |
| MS74-221MT | 220 | ±20% | 1kHz | 1.170 | 0.36 |
| MS74-271MT | 270 | ±20% | 1kHz | 1.640 | 0.34 |
| MS74-331MT | 330 | ±20% | 1kHz | 1.860 | 0.32 |
| MS74-391MT | 390 | ±20% | 1kHz | 2.850 | 0.29 |
| MS74-471MT | 470 | ±20% | 1kHz | 3.010 | 0.26 |
| MS74-561MT | 560 | ±20% | 1kHz | 3.620 | 0.23 |
| MS74-681MT | 680 | ±20% | 1kHz | 4.630 | 0.22 |
| MS74-821MT | 820 | ±20% | 1kHz | 5.200 | 0.20 |
| MS74-102MT | 1000 | ±20% | 1kHz | 6.000 | 0.18 |

Isat: 飽和電流, 加Isat時, 電感值相對初始值下降 < 20%

Isat: Saturation Current, the current when the inductance becomes 20% lower than its initial value.

MS104R Series

| 型號 Part Number | 電感量 L(μH) | 公差 Tolerance | 測試頻率 Test Freq. | 直流電阻 DCR(Ω)Max | Isat(A) |
|-------------------|--------------|-----------------|--------------------|-------------------|---------|
| MS104R-1R5NT | 1.5 | ±30% | 100kHz | 0.017 | 10.0 |
| MS104R-2R5NT | 2.5 | ±30% | 100kHz | 0.021 | 7.50 |
| MS104R-3R3NT | 3.3 | ±30% | 100kHz | 0.035 | 6.00 |
| MS104R-3R8NT | 3.8 | ±30% | 100kHz | 0.035 | 6.00 |
| MS104R-4R7NT | 4.7 | ±30% | 100kHz | 0.028 | 5.50 |
| MS104R-5R2NT | 5.2 | ±30% | 100kHz | 0.028 | 5.50 |
| MS104R-7R0NT | 7.0 | ±30% | 100kHz | 0.038 | 4.80 |
| MS104R-100MT | 10 | ±20% | 100kHz | 0.043 | 4.40 |
| MS104R-120MT | 12 | ±20% | 100kHz | 0.060 | 4.00 |
| MS104R-150MT | 15 | ±20% | 100kHz | 0.068 | 3.60 |
| MS104R-180MT | 18 | ±20% | 100kHz | 0.070 | 3.30 |
| MS104R-220MT | 22 | ±20% | 100kHz | 0.090 | 2.90 |
| MS104R-270MT | 27 | ±20% | 100kHz | 0.117 | 2.60 |
| MS104R-330MT | 33 | ±20% | 100kHz | 0.120 | 2.40 |
| MS104R-470MT | 47 | ±20% | 100kHz | 0.190 | 2.10 |
| MS104R-680MT | 68 | ±20% | 100kHz | 0.350 | 1.50 |
| MS104R-820MT | 82 | ±20% | 100kHz | 0.385 | 1.45 |
| MS104R-101MT | 100 | ±20% | 100kHz | 0.430 | 1.35 |
| MS104R-151MT | 150 | ±20% | 100kHz | 0.506 | 1.15 |
| MS104R-181MT | 180 | ±20% | 100kHz | 0.627 | 1.00 |
| MS104R-221MT | 220 | ±20% | 100kHz | 0.756 | 0.92 |
| MS104R-271MT | 270 | ±20% | 100kHz | 0.950 | 0.75 |
| MS104R-331MT | 330 | ±20% | 100kHz | 1.090 | 0.70 |
| MS104R-471MT | 470 | ±20% | 100kHz | 1.900 | 0.60 |

MS124 Series

| 型號 Part Number | 電感量 L(μH) | 公差 Tolerance | 測試頻率 Test Freq. | 直流電阻 DCR(Ω)Max | Isat(A) |
|-------------------|--------------|-----------------|--------------------|-------------------|---------|
| MS124-1R0NT | 1.0 | ±30% | 100kHz | 0.008 | 12.00 |
| MS124-1R6NT | 1.6 | ±30% | 100kHz | 0.009 | 8.00 |
| MS124-3R9NT | 3.9 | ±30% | 100kHz | 0.018 | 6.50 |
| MS124-4R7NT | 4.7 | ±30% | 100kHz | 0.022 | 5.70 |
| MS124-6R2NT | 6.2 | ±30% | 100kHz | 0.028 | 4.90 |
| MS124-6R8NT | 6.8 | ±30% | 100kHz | 0.028 | 4.90 |
| MS124-100MT | 10 | ±20% | 100kHz | 0.035 | 4.50 |
| MS124-120MT | 12 | ±20% | 100kHz | 0.038 | 4.00 |
| MS124-150MT | 15 | ±20% | 100kHz | 0.050 | 3.20 |
| MS124-180MT | 18 | ±20% | 100kHz | 0.057 | 3.10 |
| MS124-220MT | 22 | ±20% | 100kHz | 0.066 | 2.90 |
| MS124-270MT | 27 | ±20% | 100kHz | 0.080 | 2.80 |
| MS124-330MT | 33 | ±20% | 100kHz | 0.097 | 2.70 |
| MS124-390MT | 39 | ±20% | 100kHz | 0.132 | 2.10 |
| MS124-470MT | 47 | ±20% | 100kHz | 0.150 | 1.90 |
| MS124-560MT | 56 | ±20% | 100kHz | 0.190 | 1.80 |
| MS124-680MT | 68 | ±20% | 100kHz | 0.220 | 1.50 |
| MS124-820MT | 82 | ±20% | 100kHz | 0.260 | 1.30 |
| MS124-101MT | 100 | ±20% | 100kHz | 0.308 | 1.20 |
| MS124-121MT | 120 | ±20% | 100kHz | 0.380 | 1.10 |
| MS124-151MT | 150 | ±20% | 100kHz | 0.530 | 0.95 |
| MS124-181MT | 180 | ±20% | 100kHz | 0.620 | 0.85 |
| MS124-221MT | 220 | ±20% | 100kHz | 0.700 | 0.80 |
| MS124-271MT | 270 | ±20% | 100kHz | 0.876 | 0.60 |
| MS124-331MT | 330 | ±20% | 100kHz | 0.990 | 0.50 |
| MS124-471MT | 470 | ±20% | 100kHz | 1.300 | 0.40 |
| MS124-152MT | 1500 | ±20% | 100kHz | 4.000 | 0.29 |
| MS124-333MT | 33000 | ±20% | 100kHz | 95.000 | 0.07 |

Isat: 飽和電流, 加Isat時, 電感值相對初始值下降 ≤20%

Isat: Saturation Current, the current when the inductance becomes 20% lower than its initial value.

MS125 Series

| 型號 Part Number | 電感量 L(μH) | 公差 Tolerance | 測試頻率 Test Freq. | 直流電阻 DCR(Ω)Max | Isat(A) |
|-------------------|--------------|-----------------|--------------------|-------------------|---------|
| MS125-1R3NT | 1.3 | ±30% | 100kHz | 0.012 | 8.00 |
| MS125-2R1NT | 2.1 | ±30% | 100kHz | 0.014 | 7.00 |
| MS125-3R1NT | 3.1 | ±30% | 100kHz | 0.017 | 6.00 |
| MS125-4R4NT | 4.4 | ±30% | 100kHz | 0.020 | 5.00 |
| MS125-5R8NT | 5.8 | ±30% | 100kHz | 0.021 | 4.40 |
| MS125-7R5NT | 7.5 | ±30% | 100kHz | 0.024 | 4.20 |
| MS125-100MT | 10 | ±20% | 1kHz | 0.025 | 4.00 |
| MS125-120MT | 12 | ±20% | 1kHz | 0.027 | 3.50 |
| MS125-150MT | 15 | ±20% | 1kHz | 0.030 | 3.30 |
| MS125-180MT | 18 | ±20% | 1kHz | 0.034 | 3.00 |
| MS125-220MT | 22 | ±20% | 1kHz | 0.042 | 2.80 |
| MS125-270MT | 27 | ±20% | 1kHz | 0.051 | 2.30 |
| MS125-330MT | 33 | ±20% | 1kHz | 0.065 | 2.10 |
| MS125-390MT | 39 | ±20% | 1kHz | 0.068 | 2.00 |
| MS125-470MT | 47 | ±20% | 1kHz | 0.075 | 1.80 |
| MS125-560MT | 56 | ±20% | 1kHz | 0.110 | 1.70 |
| MS125-680MT | 68 | ±20% | 1kHz | 0.120 | 1.50 |
| MS125-820MT | 82 | ±20% | 1kHz | 0.140 | 1.40 |
| MS125-101MT | 100 | ±20% | 1kHz | 0.198 | 1.30 |
| MS125-121MT | 120 | ±20% | 1kHz | 0.220 | 1.10 |
| MS125-151MT | 150 | ±20% | 1kHz | 0.230 | 1.00 |
| MS125-181MT | 180 | ±20% | 1kHz | 0.290 | 0.90 |
| MS125-221MT | 220 | ±20% | 1kHz | 0.400 | 0.80 |
| MS125-271MT | 270 | ±20% | 1kHz | 0.460 | 0.75 |
| MS125-331MT | 330 | ±20% | 1kHz | 0.510 | 0.68 |
| MS125-391MT | 390 | ±20% | 1kHz | 0.690 | 0.65 |
| MS125-471MT | 470 | ±20% | 1kHz | 0.770 | 0.58 |
| MS125-561MT | 560 | ±20% | 1kHz | 0.860 | 0.54 |
| MS125-681MT | 680 | ±20% | 1kHz | 1.200 | 0.48 |
| MS125-821MT | 820 | ±20% | 1kHz | 1.340 | 0.43 |
| MS125-102MT | 1000 | ±20% | 1kHz | 1.900 | 0.40 |
| MS125-472MT | 4700 | ±20% | 1kHz | 8.280 | 0.30 |
| MS125-802MT | 8000 | ±20% | 1kHz | 15.000 | 0.22 |
| MS125-103MT | 10000 | ±20% | 1kHz | 20.000 | 0.12 |

Isat: 飽和電流, 加Isat時, 電感值相對初始值下降 ≤20%

Isat: Saturation Current, the current when the inductance becomes 20% lower than its initial value.

MS127 Series

| 型號 Part Number | 電感量 L(μH) | 公差 Tolerance | 測試頻率 Test Freq. | 直流電阻 DCR(Ω)Max | Isat(A) |
|-------------------|--------------|-----------------|--------------------|-------------------|---------|
| MS127-1R0NT | 1.0 | ± 30% | 100kHz | 0.0070 | 9.80 |
| MS127-2R2NT | 2.2 | ± 30% | 100kHz | 0.0115 | 7.50 |
| MS127-3R3NT | 3.3 | ± 30% | 100kHz | 0.0135 | 7.50 |
| MS127-4R7NT | 4.7 | ± 30% | 100kHz | 0.0158 | 6.80 |
| MS127-100MT | 10 | ± 20% | 1kHz | 0.0216 | 5.40 |
| MS127-120MT | 12 | ± 20% | 1kHz | 0.0243 | 4.90 |
| MS127-150MT | 15 | ± 20% | 1kHz | 0.0270 | 4.50 |
| MS127-180MT | 18 | ± 20% | 1kHz | 0.0392 | 3.90 |
| MS127-220MT | 22 | ± 20% | 1kHz | 0.0432 | 3.60 |
| MS127-270MT | 27 | ± 20% | 1kHz | 0.0459 | 3.40 |
| MS127-330MT | 33 | ± 20% | 1kHz | 0.0648 | 3.00 |
| MS127-390MT | 39 | ± 20% | 1kHz | 0.0729 | 2.75 |
| MS127-470MT | 47 | ± 20% | 1kHz | 0.1000 | 2.50 |
| MS127-560MT | 56 | ± 20% | 1kHz | 0.110 | 2.35 |
| MS127-680MT | 68 | ± 20% | 1kHz | 0.140 | 2.10 |
| MS127-820MT | 82 | ± 20% | 1kHz | 0.160 | 1.95 |
| MS127-101MT | 100 | ± 20% | 1kHz | 0.220 | 1.70 |
| MS127-121MT | 120 | ± 20% | 1kHz | 0.250 | 1.60 |
| MS127-151MT | 150 | ± 20% | 1kHz | 0.280 | 1.42 |
| MS127-181MT | 180 | ± 20% | 1kHz | 0.350 | 1.30 |
| MS127-221MT | 220 | ± 20% | 1kHz | 0.390 | 1.16 |
| MS127-271MT | 270 | ± 20% | 1kHz | 0.560 | 1.06 |
| MS127-331MT | 330 | ± 20% | 1kHz | 0.640 | 0.95 |
| MS127-391MT | 390 | ± 20% | 1kHz | 0.700 | 0.88 |
| MS127-471MT | 470 | ± 20% | 1kHz | 0.980 | 0.79 |
| MS127-561MT | 560 | ± 20% | 1kHz | 1.070 | 0.73 |
| MS127-681MT | 680 | ± 20% | 1kHz | 1.460 | 0.67 |
| MS127-821MT | 820 | ± 20% | 1kHz | 1.640 | 0.60 |
| MS127-102MT | 1000 | ± 20% | 1kHz | 1.820 | 0.55 |

Isat: 飽和電流，加Isat時，電感值相對初始值下降 ≤ 20%

Isat: Saturation Current, the current when the inductance becomes 20% lower than its initial value.